

- Key:**
- Proposed Road Markings
 - Proposed Traffic Regulation Orders
 - No waiting at any time
 - No loading, Monday-Friday, 7-10AM and 4-7PM
 - No parking, loading or unloading at any time on the footway or cycle track
 - Proposed Bus Stop Clearway
 - Mandatory Cycle Lane (Advisory at access locations)
 - Existing Traffic Regulation Order

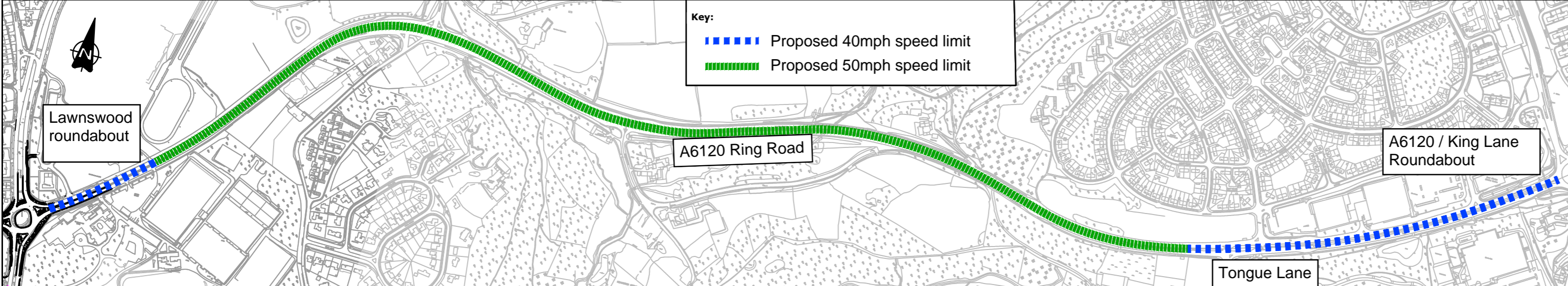
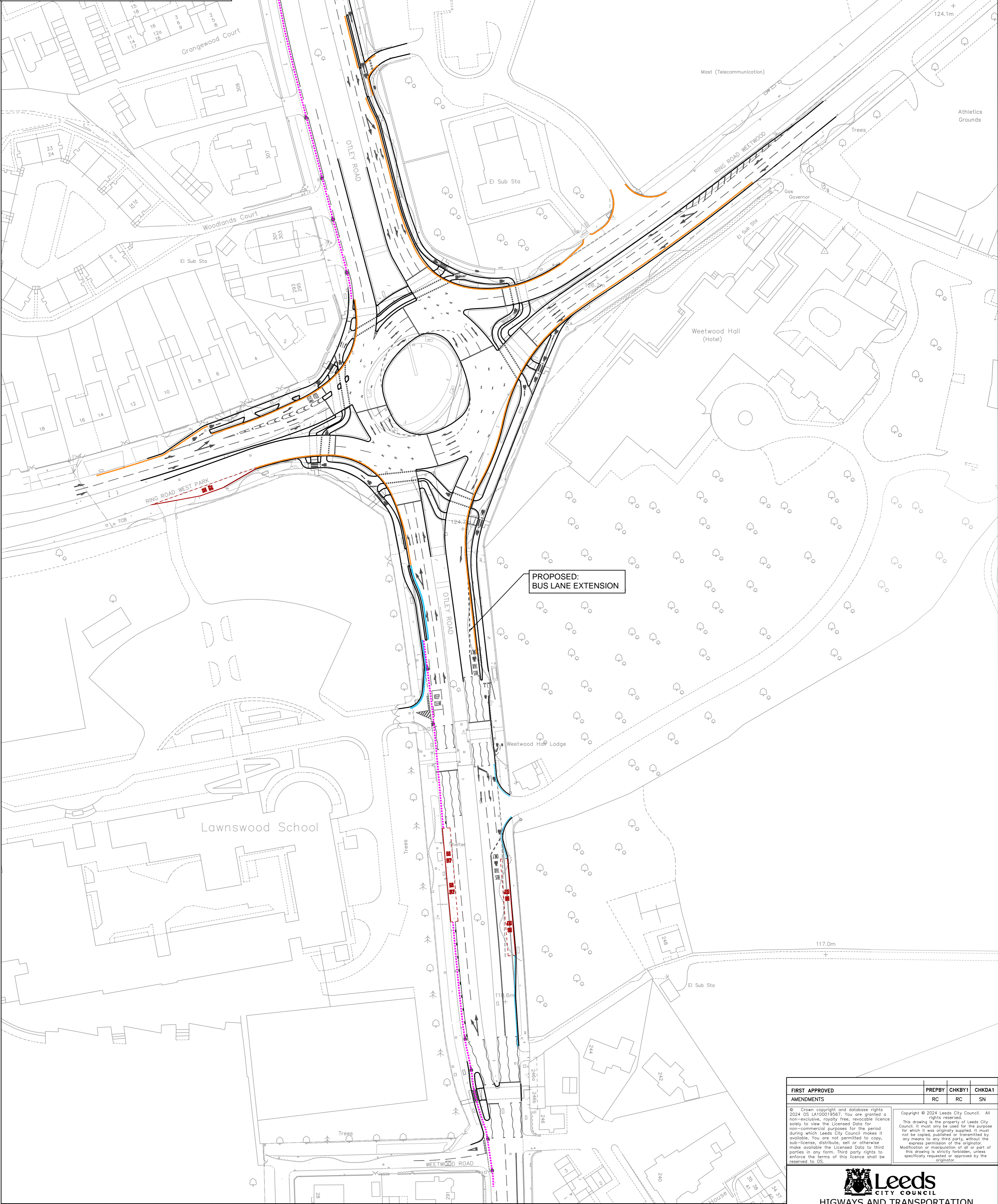

FIRST APPROVED	PREPBY	CHKBY1	CHKDA1
AMENDMENTS	RC	RC	SN

© Crown copyright and database rights 2024 OS LA100019567. You are granted a non-exclusive, royalty free, revocable licence solely to view the Licensed Data for non-commercial purposes for the period during which Leeds City Council makes it available. You are not permitted to copy, sub-licence, distribute, sell or otherwise make available the Licensed Data to third parties in any form. Third party rights to enforce the terms of this licence shall be reserved to OS.

Copyright © 2024 Leeds City Council. All rights reserved. This drawing is the property of Leeds City Council; it must only be used for the purpose for which it was originally supplied. It must not be copied, published or transmitted by any means to any third party, without the express permission of the originator. Modification or manipulation of all or part of this drawing is strictly forbidden, unless specifically requested or approved by the originator.



LAWNSWOOD ROUNDABOUT TRAFFIC REGULATION ORDERS

DRAWN BY	SCALE	DRAWING NUMBER:
RC	11/24	733418/LCC/XXX/LR/DR/CH/GA/TRO
AUTHOR BY		
INITIALS	DATE	N.T.S.
RC	11/24	
CHECKED BY		
INITIALS	DATE	FOR CONSULTATION ONLY
SN	11/24	DATE: NOV 2024
	ORIGINAL SHEET SIZE	A1